

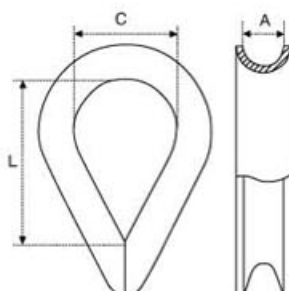

### Thimble DIN6899A 欧式套环



Sell-φ	A	L	C	Sell-φ	A	L	C
mm	mm	mm	mm	mm	mm	mm	mm
2.5	3.0	21.5	10	10.0	11.0	47.5	22
3.0	3.5	23.5	11	11.0	12.0	51.5	24
3.5	4.0	26.5	12	12.0	13.0	56.5	26
4.0	5.0	28.5	13	13.0	14.0	61.5	28
5.0	6.0	30.0	14	15.0	16.0	69.5	32
6.0	7.0	33.0	15	16.0	18.0	78.0	35
7.0	8.0	35.0	16	18.0	20.0	86.5	40
8.0	9.0	39.0	18	20.0	22.0	95.0	44
9.0	10.0	43.0	20	24/26	26.0	105.0	48

### US Thimble G411 美式薄型套环

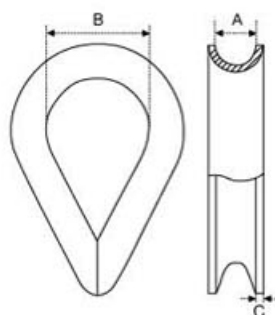

Sell-φ	A	B	C
mm	mm	mm	mm
1/8"	17	33	1.2
3/16"	17.5	33	1.2
1/4"	18	33	1.2
5/16"	20.5	38	1.2
3/8"	24	42	1.5
1/2"	29	48	2
5/8"	35	57	3
3/4"	41	64	3.5
7/8"	48	89	4
1"	64	108	4
1 1/8"-1 1/4"	70	115	5.5

### US Thimble G414 美式厚型套环

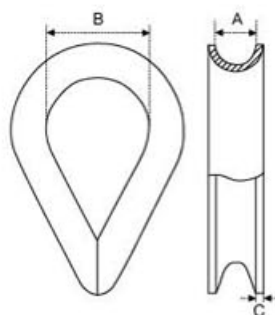

Sell-φ	A	B	C
mm	mm	mm	mm
1/4"	22	41	1.5
5/16"	27	48	2
3/8"	29	54	3
7/16"	32	61	3
1/2"	38	70	3.5
9/16"	38	72	3.5
5/8"	44	82	4
3/4"	51	95	5.5
7/8"	64	108	5.5
1"	73	114	6
1 1/8"-1 1/4"		130	6

### Thimbles European Commercial 意式套环

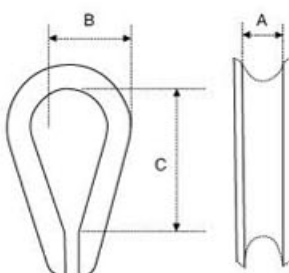

SIZE	A	B	C	SIZE	A	B	C
mm	mm	mm	mm	mm	mm	mm	mm
12	12	38	51	14	14	40	57
4	4	11	16	16	16	42	60
5	5	16	22	18	18	45	67
6	6	19	26	20	20	51	76
7	7	22	32	22	22	54	83
8	8	24	34	24	24	64	88
9	9	29	38	26	26	68	102
10	10	32	42	28	28	73	110
11	11	35	48				