

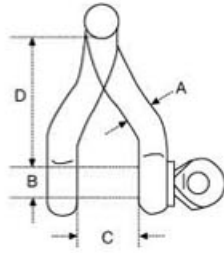

### Twisted Shackles 扭体卸扣



Size A	B	C	D
mm	mm	mm	mm
4	4	8	23
5	5	10	28
6	6	12	33
8	8	16	44
10	10	20	55
12	12	24	66

### Eu&Jis Dee Shackle D形卸扣

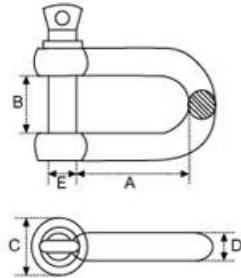

Size mm	A		B		C		D		E	
	Eu	Jis	Eu	Jis	Eu	Jis	Eu	Jis	Eu	Jis
4	16	14	8	8	8	8	4	4	4	4
5	20	16	10	10	10	10	5	5	5	5
6	24	22	12	12	12	12	6	6	6	6
8	32	27	16	16	16	16	8	8	8	8
10	40	31	20	20	20	20	10	10	10	10
12	48	40	24	24	24	24	12	12	12	12
14	56	46	28	28	28	28	14	14	14	14
16	64	52	32	32	32	32	16	16	16	16
18	72	58	36	36	36	36	18	18	18	18
20	76	64	40	40	40	40	20	20	20	20
22	88	75	44	44	44	44	22	22	22	22
25	100	83	50	50	50	50	25	25	25	25
28	112	96	56	56	56	56	28	28	28	28
32	128	114	64	64	64	64	32	32	32	32
36	144	116	72	72	72	72	36	36	36	36

### Eu & Jis Bow Shackle 弓形卸扣

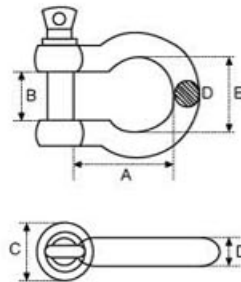

Size mm	A		B		C		D		E	
	Eu	Jis	Eu	Jis	Eu	Jis	Eu	Jis	Eu	Jis
4	16	16	8	8	8	8	4	4	12	14
5	20	19	10	10	10	10	5	5	15	16
6	24	25	12	12	12	12	6	6	18	20
8	32	32	16	16	16	16	8	8	24	24
10	40	38	20	20	20	20	10	10	30	28
12	48	48	24	24	24	24	12	12	36	36
14	56	50	28	28	28	28	14	14	42	38
16	64	55	32	32	32	32	16	16	48	40
18	72	62	36	36	36	36	18	18	54	43
20	76	68	40	40	40	40	20	20	60	46
22	88	82	44	44	44	44	22	22	66	56
25	100	95	50	50	50	50	25	25	75	68
28	112	108	56	56	56	56	28	28	84	74
32	128	120	64	64	64	64	32	32	96	84
36	144	135	72	72	72	72	36	36	108	92

### US Type Dee Shackle G210 美式直型卸扣

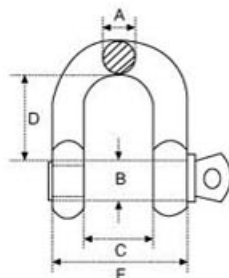

Size	A	B	C	D	E
3/16	5	6	10	19	20
1/4	6	8	13	22	25
5/16	8	10	14	26	30
3/8	10	12	17	32	37
7/16	11	12	18	36	40
1/2	12	14	21	41	45
5/8	16	18	27	51	59
3/4	20	22	32	60	72
7/8	22	25	37	71	81
1	25	28	43	81	93
1-1/8	28	30	46	90	102
1-1/4	32	36	51	100	115



### Swivel Snap Shackles With Eye End 环式旋转弹簧卸扣

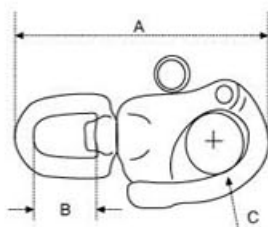

Size	A	B	C	Wll
mm	mm	mm	mm	T
12 × 70	70	12	12	0.275
16 × 87	87	12	16	0.500
22 × 128	120	16	22	0.875

### Swivel Snap Shackles With Jaw 叉式旋转弹簧卸扣

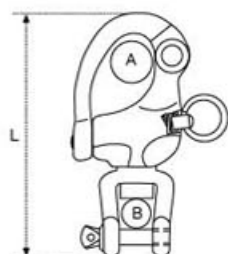

Size	A	B	C	Wll
mm	mm	mm	mm	T
12 × 70	12	12	69	0.275
16 × 87	12	16	90	0.500
22 × 128	22	22	128	0.875

### Fixde Snap Shackles 固定弹簧卸扣

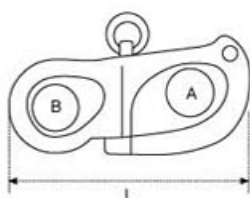

Size	A	B	C	Wll
mm	mm	mm	mm	T
12 × 52	52	12	9	0.275
16 × 66	66	16	12	0.500
22 × 96	96	22	16	0.875

### Long Dee shackle 长D卸扣

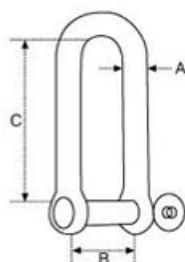

Size	A	B	C
mm	mm	mm	mm
4	4	8	30
5	5	10	37
6	6	12	45
8	8	16	60
10	10	20	75
12	12	24	90
14	14	28	105
16	16	32	120



### US Type Anchor Shackle G209 美式弓型卸扣

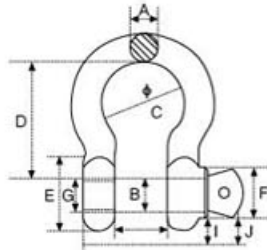

Size	A	B	C	D	E	F	G	H	I	J
3/16	5	6	16	22	13	9.5	6	2	5	
1/4	6	8	20	28	15.5	11.5	8	2.5	6	
5/16	8	10	21	30	19	13.5	10	3	8	
3/8	10	12	26	52	23	16	12	3.5	10	
7/16	11	12	29	42	27	16.5	12	3.5	11	
1/2	12	14	33	47	30	21.5	14	4.5	12	
5/8	16	18	43	60	38	27	18	5.5	16	
3/4	20	22	51	71	46	30	22	6	20	
7/8	22	25	58	83	53	34	24	6	22	
1	25	28	68	95	60	36	27	6.5	25	
1-1/8	28	30	74	107	68	40	30	6.5	28	
9/16	14	16	38	53	34	24	16	5	14	

### US Security Dee Shackles G2150 美式直型保險卸扣

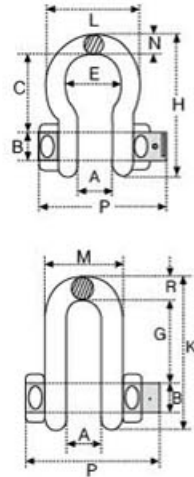

Nominal Size (in.)	WLL (t) <sup>*</sup>	A	B	C	D	E	F	G	H	K	L	M	N	P	R
3/16	1/3	0.38	0.25	0.88	0.19	0.60	0.56	--	1.47	--	0.98	--	0.19	1.29	--
1/4	1/2	0.47	0.31	1.13	0.25	0.78	0.61	--	1.84	--	1.28	--	0.25	1.56	--
5/16	3/4	0.53	0.38	1.22	0.31	0.84	0.75	--	2.09	--	1.47	--	0.31	1.82	--
3/8	1	0.66	0.44	1.44	0.38	1.03	0.91	--	2.49	--	1.78	--	0.38	2.17	--
7/16	1-1/2	0.75	0.50	1.69	0.44	1.16	1.06	--	2.91	--	2.03	--	0.44	2.51	--
1/2	2	0.81	0.63	1.88	0.50	1.31	1.19	1.63	3.28	3.03	2.31	1.81	0.50	2.80	0.50
5/8	3-1/4	1.06	0.75	2.38	0.63	1.69	1.50	2.00	4.19	3.75	2.94	2.31	0.69	3.53	0.63
3/4	4-3/4	1.25	0.88	2.81	0.75	2.00	1.81	2.38	4.97	4.53	3.50	2.75	0.81	4.07	0.81
7/8	6-1/2	1.44	1.00	3.31	0.88	2.28	2.09	2.81	5.83	5.33	4.03	3.19	0.97	4.71	0.97
1	8-1/2	1.69	1.13	3.75	1.00	2.69	2.38	3.19	6.56	5.94	4.96	3.69	1.06	5.31	1.00
1-1/8	9-1/2	1.81	1.25	4.25	1.13	2.91	2.69	3.58	7.47	6.78	5.16	4.06	1.25	5.09	1.25
1-1/4	12	2.03	1.38	4.69	1.25	3.25	3.00	3.94	8.25	7.50	5.75	4.53	1.38	6.51	1.38
1-3/8	13-1/2	2.25	1.50	5.25	1.38	3.63	3.31	4.38	9.16	8.28	6.38	5.00	1.50	7.21	1.50
1-1/2	17	2.38	1.63	5.75	1.50	3.88	3.63	4.81	10.00	9.05	6.88	5.38	1.62	7.73	1.62
1-3/4	25	2.88	2.00	7.00	1.75	5.00	4.19	5.75	12.34	10.97	8.86	6.38	2.25	9.05	2.12
2	35	3.25	2.25	7.75	2.00	5.75	4.85	6.75	13.68	12.28	9.97	7.25	2.40	10.41	2.00
2-1/2	55	4.13	2.75	10.5	2.62	7.25	5.69	8.00	17.84	14.84	12.87	9.38	3.13	13.56	2.62
3	85	5.00	3.25	13.0	3.00	7.88	6.50	8.50	21.50	16.88	14.36	11.00	3.62	16.50	3.50

### US Security Bow shackle 美式弓型保險卸扣

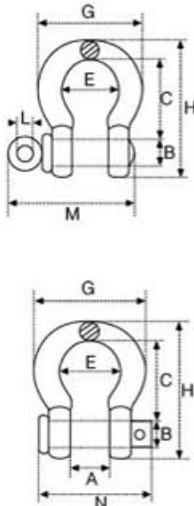

Nominal Size (in.)	WLL (t) <sup>*</sup>	A	B	C	D	E	F	G	H	L	M	N	P
3/16	1/3	0.38	0.25	0.88	0.19	0.60	0.56	0.98	1.47	0.16	1.12	--	0.19
1/4	1/2	0.47	0.31	1.13	0.25	0.78	0.61	1.28	1.84	0.19	1.38	1.34	0.25
5/16	3/4	0.53	0.38	1.22	0.31	0.84	0.75	1.47	2.09	0.22	1.66	1.59	0.31
3/8	1	0.66	0.44	1.44	0.38	1.03	0.91	1.78	2.49	.25	2.03	1.86	0.38
7/16	1-1/2	0.75	0.50	1.69	0.44	1.16	1.06	2.03	2.91	0.31	2.38	2.13	0.44
1/2	2	0.81	0.63	1.88	0.50	1.31	1.19	2.31	3.28	0.38	2.69	2.38	0.50
5/8	3-1/4	1.06	0.75	2.38	0.63	1.69	1.50	2.94	4.19	0.44	2.34	2.91	0.69
3/4	4-3/4	1.25	0.88	2.81	0.75	2.00	1.81	3.50	4.97	0.50	3.97	3.44	0.81
7/8	6-1/2	1.44	1.00	3.31	0.88	2.28	2.09	4.03	5.83	0.50	4.50	3.81	0.97
1	8-1/2	1.69	1.13	3.75	1.00	2.69	2.38	4.69	6.56	0.56	5.07	4.53	1.06
1-1/8	9-1/2	1.81	1.25	4.25	1.16	2.91	2.69	5.16	7.47	0.63	5.59	5.13	1.25
1-1/4	12	2.03	1.38	4.69	1.29	3.25	3.00	5.75	8.25	0.69	6.16	5.50	1.38
1-3/8	13-1/2	2.25	1.50	5.25	1.42	3.63	3.31	6.38	9.16	0.75	6.84	6.13	1.50
1-1/2	17	2.38	1.63	5.75	1.54	3.88	3.63	6.88	10.00	0.81	7.35	6.50	1.62
1-3/4	25	2.88	2.00	7.00	1.84	5.00	4.19	8.86	12.34	1.00	9.08	7.75	2.25
2	35	3.25	2.25	7.75	2.08	5.75	4.81	9.97	13.68	1.22	10.34	8.75	2.40
2-1/2	55	4.13	2.75	10.50	2.71	7.25	5.69	12.87	17.84	1.38	13.00	--	3.13